

# Model : 6-FM-18

GP SERIES

### General Series

General Series Valve Regulated Lead Acid batteries are designed with AGM (Absorbent Glass Mat) technology, high performance plates and electrolyte to gain extra power output for common power backup system applications widely used in the field of UPS, Emergency Lighting System.

### Application

- Alarm System
- Cable Television
- Communication Equipment
- Control Equipment
- Security System
- Medical Equipment
- UPS
- Power tools
- Emergency Power System
- Toys

### General Features

- Sealed and maintenance free operation.
- Non-Spillable construction design.
- ABS containers and covers(UL94HB, UL94V-0) optional.
- Safety valve installation for explosion proof.
- High quality and high reliability.
- Exceptional deep discharge recovery performance.
- Low self discharge characteristic.
- Flexibility design for multiple install positions.

### Construction

- Component .....Raw material
- Positive .....Lead dioxide
- Negative .....Lead
- Container .....ABS
- Cover .....ABS
- Sealant .....Epoxy Resin
- Safety valve .....EPDR
- Terminal .....Copper
- Separator .....Fiber glass
- Electrolyte .....Sulfuric acid

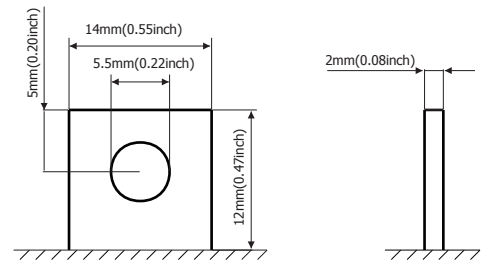

Terminal Dimensions

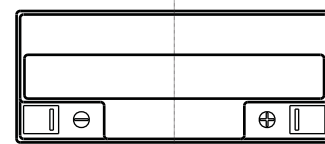
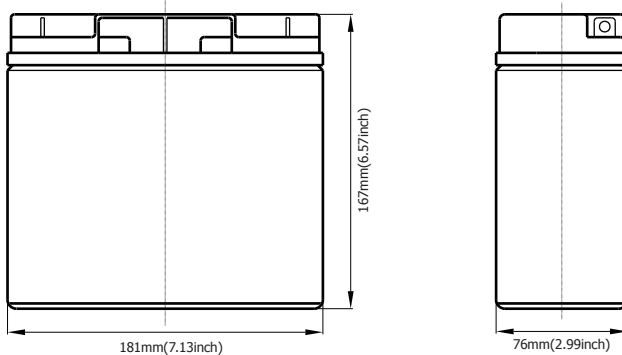

Battery Model	6-FM-18			
Designed Floating Life	5 Years			
Capacity(25°C)	20HR(0.90A,1.80V)	10HR(1.66A,1.80V)	5HR(3.22A,1.75V)	1HR(12.8A,1.60V)
	18.0AH	16.6AH	16.1AH	12.8AH
Dimensions	Length	Width	Height	Total Height
	181mm(7.13inch)	76mm(2.99inch)	167mm(6.57inch)	167mm(6.57inch)
Approx. Weight	5.25Kg (11.6 lbs)			
Internal Resistance	Full charged at 25°C: 0.012 Ohm			
Self Discharge	3% of capacity declined per month at (25°C)			
Capacity Affected by Temp.(20HR)	40°C	25°C	0°C	-15°C
	102%	100%	85%	65%
Charge Voltage(25°C)	Cycle use		Float use	
	14.4-15V(-30mV/ °C), max. Current: 5.4A		13.6-13.8V(-20mV/ °C)	

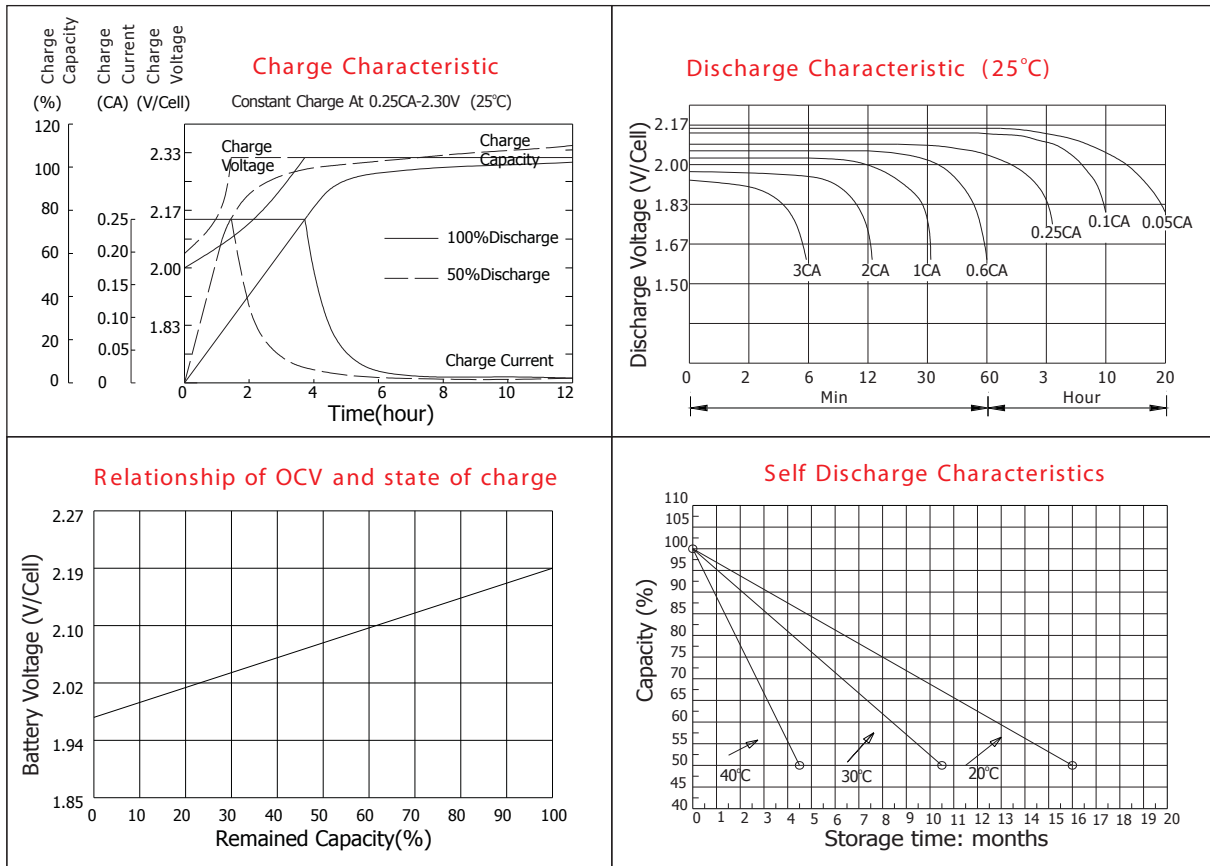

Constant current discharge ratings-amperes at 25°C

F.V/Time	5MIN	10MIN	15MIN	30MIN	1HR	3HR	5HR	10HR	20HR
1.60V	77.4	51.2	38.0	23.1	12.8	5.62	3.43	1.73	1.01
1.67V	72.6	48.6	36.5	22.1	12.6	5.40	3.36	1.71	0.97
1.70V	66.5	46.8	35.7	20.1	12.2	5.04	3.29	1.70	0.96
1.75V	65.2	45.3	34.5	19.1	11.7	4.87	3.22	1.68	0.93
1.80V	58.3	43.3	31.3	17.7	10.9	4.68	3.02	1.66	0.91
1.85V	51.5	41.2	28.2	16.3	10.2	4.51	2.83	1.64	0.88

Constant power discharge ratings-watts at 25°C

F.V/Time	5MIN	10MIN	15MIN	30MIN	1HR	3HR	5HR	10HR	20HR
1.60V	136	92.4	69.3	41.7	23.1	9.96	6.34	3.46	2.02
1.67V	131	90.1	68.4	40.8	22.9	9.65	6.31	3.43	1.94
1.70V	123	89.2	67.9	38.2	22.5	9.22	6.23	3.41	1.92
1.75V	124	88.9	67.3	37.1	22.1	9.00	6.17	3.37	1.87
1.80V	114	86.3	62.4	35.4	20.9	8.74	5.98	3.33	1.82
1.85V	103	82.1	56.6	32.6	19.6	8.47	5.61	3.28	1.75

NARADA POWERSOURCE CO.,LTD.  
No.459 Wensan Road, Hangzhou, Zhejiang, P.R.China  
Tel:+86-571-28827013 Fax:+86-571-23657189  
Website:www.naradabattery.com E-mail: intl@narada.biz

NARADA ASIA PACIFIC PTE.LTD.  
65 Ubi Crescent #07-05 HOLA centre, Singapore  
Tel: +65-6848 1191 Fax: +65-6749 3498  
E-mail: sales@narada.com.sg

NARADA EUROPE (UK) LIMITED  
Spectrum House, Dunstable Road, Redbourn,  
St. Albans, Herts AL3 7PR  
Tel: +44 (0)845 371 7095 Fax:+44 (0)845 612 2031  
E-mail: sales@naradaeurope.com

